

Strautmann Umwelttechnik GmbH
Gausekamp 15
D-49326 Melle
Phone: +49 (0) 54 29 / 94 05-0
Fax: +49 (0) 54 29 / 94 05-20
E-Mail: info@strautmann-umwelt.de
Internet: www.strautmann-umwelt.de

Strautmann
Umwelttechnik

**Your specialist for
Environmental recycling
technology**

BRIQUETTING PRESS

SB 301



- **Volume reduction of up to 95 %**
- **Recycling of waste material**
- **Universally applicable**
- **Easily installed anywhere**
- **Easy handling**
- **Automatic compaction**

Compacts with 30 tonnes

- **PET bottles**
- **cardboard, paper**
- **EPS**
- **aluminium chips, etc.**
- **cans**
- **Tetrapak**
- **etc.**



...into manageable waste

**PROFITABLE WASTE MANAGEMENT –
WITH STRAUTMANN**

BRIQUETTING PRESS

SB 301

► total automatic compression system

- after filling the hopper with the waste material the pre-compression and compression of the material will start automatically
- the compressed briquettes will be pushed continuously through the exit channel and can be removed by means of any container

► volume reduction up to 95 %

- high surface pressing power of up to 4688 t / m²

► high density of briquettes

- e.g. **SERIEPET** with up to 650 kg* / m² of PET bottles
- e.g. **SERIEPAPER** with up to 850 kg* / m² of cardboard
- e.g. **SERIECANS** with up to 750 kg* / m² of aluminium
- e.g. **SERIESTYRO** with up to 700 kg* / m² of EPS

► high capacity per hour

- **SERIEPET** with up to 200 kg* / h of PET bottles
- **SERIEPAPER** with up to 300 kg* / h of cardboard / paper
- **SERIECANS** with up to 100 kg* / h of aluminium
- **SERIESTYRO** with up to 150 kg* / h of EPS

► continuous feeding

- loading of material during the briquetting process
- feeding by suction plant is possible in combination with automatic start

► high control comfort

- SPS control type Siemens
- handle directions by touch screen
- low-noise with less than 80 dB while idle

► large loading aperture

- easy filling due to large feeding opening 900 x 600 mm

► large chamber capacity

- large feeding chamber of 0,5 m²

► high security standards

- manufactured according to CE standards

► universally applicable

- compact design
- small floor area requirement under 8 m²
- low height of the machine with 2,55 m

► Premium Package for machine power 9,2 kW - 18 kW

- automatic start by filling level control
- automatic machine stop by empty press channel
- red flashing blade protection light
- hydraulic aggregate for separate installation
- Touchpanel
- SPS control
- removable hopper for cleaning purposes type **Strautmann QuickMove**
- central lubrication
- electronically adjustable compression

► options

- exit channel adjustable
- hopper
- stainless steel feet
- cleaning package
- frame made complete or partly of stainless steel for wet operation
- winterpackage
- data exchange

► briquette distribution systems

- for open containers up to 40 m²
- for 1 to 4 containers

► pre-compressing systems

- for PET bottles in foil bags
- for cardboard

► other machines in series

- BP 900 capacity of max. 450 kg* /PET bottles **SERIEPET**
- BP 1800 capacity of max. 800 kg* /PET bottles **SERIEPET**
- SB 3600 capacity of max. 1200 kg* /PET bottles **SERIEPET**



Stainless steel version



Mobile recycling



Double distributor

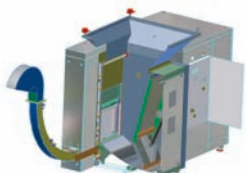

Functionary of SB 301 with options

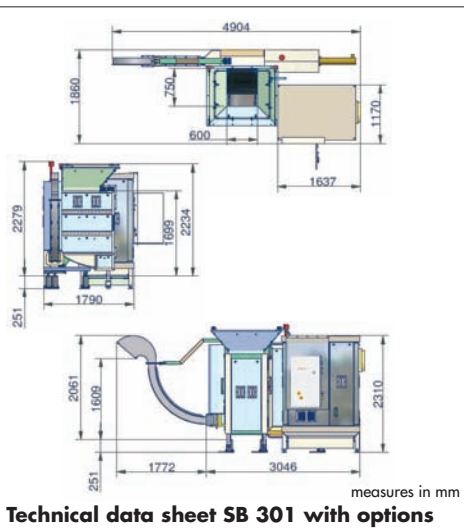

electricity supply	machine weight	pressing weight	pressing force	max. briquette dimensions
400 V / 50 Hz	1,8 t	30 t	300 kN	80 x 80 x 100-300 mm

Subject to alterations 08/2005

*Attention: weight of briquette and bulk weight depends on the material!

OTHER STRAUTMANN PRODUCTS

Single or multi chamber baling presses (bale weight from 30 to 600 kg). Rubbish bin and container compactors, balers for wet and moist waste, drumcrushers, briquetting presses, special solutions.